

Thermal Block

Our SNS® Thermal Blocks can be installed on the go (option 1) as insulation and roof sheets are installed or they can be installed all at once (option 2) with a man basket, either way, works great.

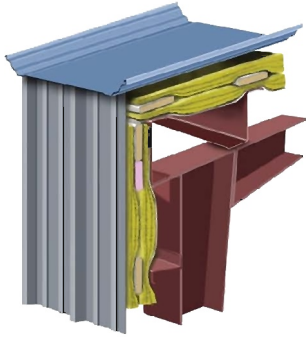

Each thermal block comes in six-foot lengths which are the standard widths of three Standing Seam Roof panels and the typical widths of a metal building insulation roll, making the thermal block easy to handle and install.

Each thermal block comes with two flat-head screws to hold the six-foot thermal block in place. (210 flat screws will be provided for 100 thermal blocks).

Suggestions:

- When installing the thermal blocks, center it over the flange of the purlin
- Butt the thermal blocks end to end without adding pressure
- Consider the placement of the flat-head screws through the thermal block, so that the SSR Panel Clip Screws are not in conflict with the flathead screws
- When installing the insulation blankets, install to industry standards to allow for full expansion of the fiberglass

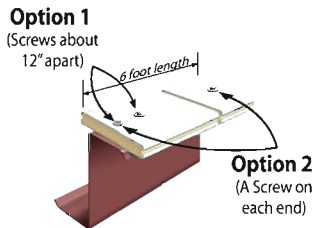

Step 1: Install SNS® Purlin Struts between purlins. (See instructional guidelines for more information)

Step 2: Thermal blocks are placed and centered over the top of the purlins and are attached by two #12 flat head screws. (Option 1) Place the first flathead screw at the end and the second screw around 12 inches from the first. (Option 2) Place the flathead screw at each end.

SSR Panel Clip

Suggestions:

- Only use clips that are ¼" taller than the profile of the panel
- Standing Seam clips should not be located over the joints of the thermal block
- Installing the SSR Panel Clip in the center to ensure the clip screws are screwed through thermal block and into the purlin flange below
- Use a longer screw to fasten the SSR Panel Clip through the thermal block and into the purlin flange below. (SNS recommends #14 or larger diameter screw and is 1" in length)

Step 3: Place the insulation blanket over the thermal blocks and attach the SSR Panel Clip on top of the insulation blanket and centered over the thermal block. The SSR Panel Clip will be fastened through the insulation blanket and the thermal block to the purlin flange, for a tight connection. Complete the additional steps of the standing seam roof as to manufacturers specifications.

The assembly process is like a typical standing seam roof. The only additional step is to set the thermal blocks in place with two flat-head screws and attach the standing seam clip through the thermal block and to the purlin flange.

Instructional Guidelines for a Double Layer Standing Seam Roof System

The only difference between the double layer and the single layer system, is the additional insulation between the purlins and the thermal block. When attaching the thermal block to the purlin, be sure to apply pressure to the thermal block, so that the thermal block is snug-tight to the purlin, using the flat-head screws. Do not compress or dimple the thermal block.

Cross-sectional view of the Double Layer Standing Seam Roof Insulation System.

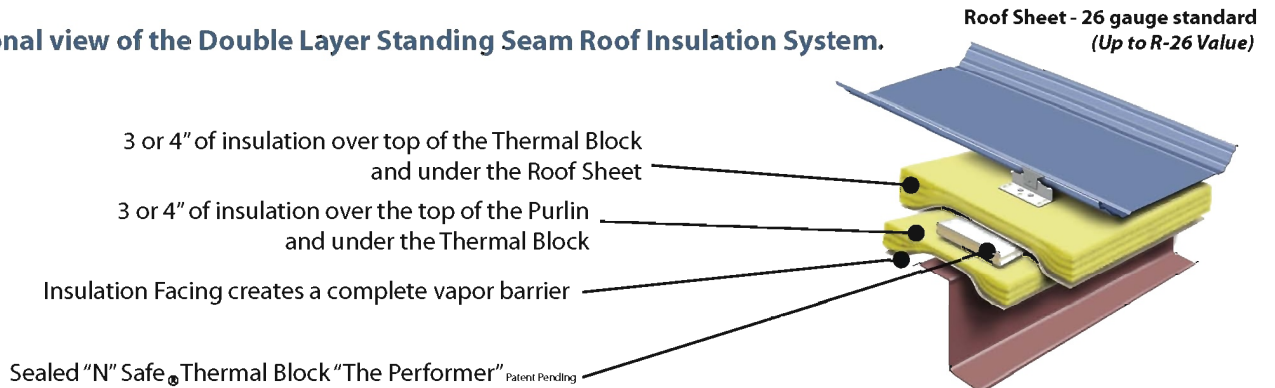

For **Steps 1, 2 and 3** of the double layer system, refer to the single layer system, on the other side of this page, and do steps 1,2 and 3. (When installing the Insulation Blankets, offset the upper and lower insulation side joints from each other to increase efficiency)

Instructional Guidelines for a Full Cavity Standing Seam Roof

Insulation Rail

Our Insulation Rail is 26ga, painted Steel Rail, which is fastened to the bottom of the purlin using #12 X 3/4" SD Screws. It is a very attractive means of not only supporting the added insulation but also supports the bottom flange of the purlin. It does not induce the tension conditions that are inherent when using banding or strapping to support the insulation. Our insulation support rails are produced in 10 & 12 foot lengths.

Step 1: Our insulation rail need to be fastened to bottom of each purlin using a #12 X 3/4" SD Screws and spaced not more then at 2' -6" apart as noted in the picture below

Cross-sectional view of the Full Cavity Standing Seam Roof Insulation System.

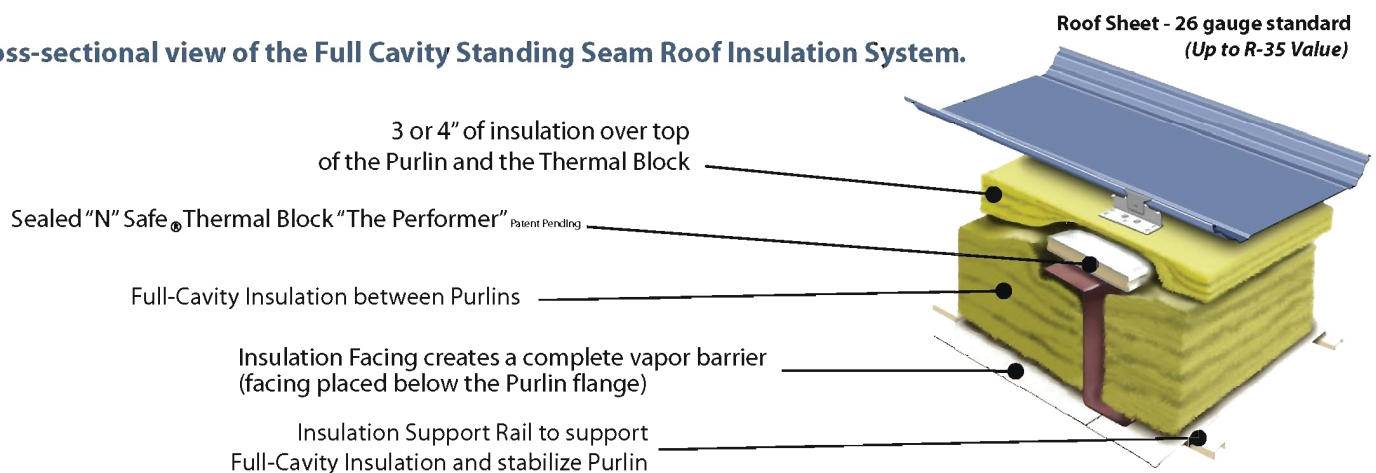

For **Steps 2, 3 and 4** of the full cavity insulation, refer to the single layer system, on the other side of this page, and do steps 1,2 and 3.



call today:
888-340-4767 www.sealednsafe.com

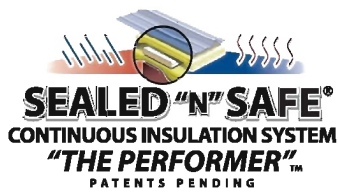

Instructional Guidelines for a Suspended Full Cavity Standing Seam Roof (Patents Pending)

SNS® Full Cavity Standing Seam Roof System

Before beginning installation of the SNS Suspended Full Cavity Insulation System, consider the following items to determine which works best for you.

1. Layout for Clips on the ground while purlins are in a bundle (Saves Time)
2. Layout for Clips after purlins are in place on the roof (Requires more time)
3. Have your building supplier pre-punch holes according to the layout you need (May cost more)
4. Install Clips on the ground before purlins are lifted in place. Remember to avoid interference at purlin laps. (Saves time but requires careful handling of purlins one at a time to lift in place)
5. Install Clips from a man basket after purlins are in place (Requires more time. Can be done as insulation rails are installed)

Conditions on your jobsite may dictate which of the above options above you wish to engage. Please note that SNS suggests you place an SNS Insulation Rail about 4 to 6" from frame web at bay ends to support a clean neat termination. Be sure to consider that in your layout. Also, maximum spacing of SNS Insulation Rails is 30" OC

Suspended System

- Step 1:** Layout and install the SNS Support Clips and purlins. If any other trades are involved in your project, have them install any other bracketry for HVAC, lighting, etc. before the insulation is installed.
- Step 2:** If purlins are straight, install the insulation rails. Rotate the rail with web in vertical position, slide it up into the clip, rotate it 90 degrees to point flanges downward, and pull down into position toward the bottom of the clip. At joints in the support rail, nest the ends together and install together.
- Step 3:** Place the lower faced blanket (from the roof top) through the purlin cavity down onto the support rails only in the purlin spaces that will receive the SNS Purlin Strut. (If the SNS Purlin Struts are not used, go ahead and install all of the lower blankets.)
- Step 4:** Install the SNS Purlin Struts over top of the lower insulation blanket, place and tighten all bolts.
- Step 5:** Install the remainder of the lower insulation blanket. At bay ends, cut away the insulation evenly the frame, leaving the facing to lay around the end of the blanket and up over the frame flange. The cavity fill blankets will lay over top of the facing. This will make a neat clean termination and should not require further process.
- Step 6:** Install the rest of the insulation between the purlins. Add thickness layers as needed.
- Step 7:** Install the SNS Thermal Blocks.
- Step 8:** Install the top 3 or 4 " unfaced layer over top of the SNS Thermal Block and install the roof system as you go.

Installation Notes

In most cases, the insulation joints parallel to the purlins need to be sealed off and air tight, especially in cold or humid climates. We suggest these methods to accomplish that.

1. Have your insulation supplier apply "Double Face Tape" to the outside of 1 tab only. Ask for a heavier or stronger protective layer to prevent tearing during its removal. Install with the facing tabs upward. Keep tabs as short as possible (2" Max) to maintain the best insulation performance. During installation, you will want the "taped" side of the insulation roll to be on the downslope edge of the insulation blanket. This will eliminate interference with purlin flanges, clips and other bracketry while removing the tapes protective layer.

Don't forget to remove the tapes protective layer. Be careful while removing to insure a neat clean appearance from below. You may want to do this as you install the insulation so you can reach across the blanket. If you are really good, you could remove the paper before you install the blanket. Keep the tabs upward for best performance.

2. Once the entire roof is completed, use a low bodied caulk to seal between the facing vertical joints. Most silicone based caulks are light bodied. Make sure the caulking is compatible with the insulation facing.
3. Pull the taps downward, roll them together, and staple together. This option may not have as neat an appearance as option 1 and 2.
4. You may an idea of your own. The goal is to seal the joints.

Cross-sectional view of the Suspended Full Cavity Standing Seam Roof Insulation System.

